

# Connecting Public Health and Food Sector Collaborators: Reducing Sodium in Food Service Settings

April 5, 2017

11 AM – 12:30 PM Pacific

2 PM – 3:30 PM Eastern

---

*Please close all applications except WebEx.*

**Audio trouble?** Send us a question in the **Q&A** panel.

**Technical trouble?** Call WebEx at **1-866-229-3239**.

Closed captioning instructions will be provided.

---

Connect with us on **Twitter** [@Dialogue4Health](https://twitter.com/Dialogue4Health) | **#ReduceSodium**

# Closed Captioning

To see real-time closed captioning:

1. Click to open **Media Viewer**



2. Click **Show/Hide Header**

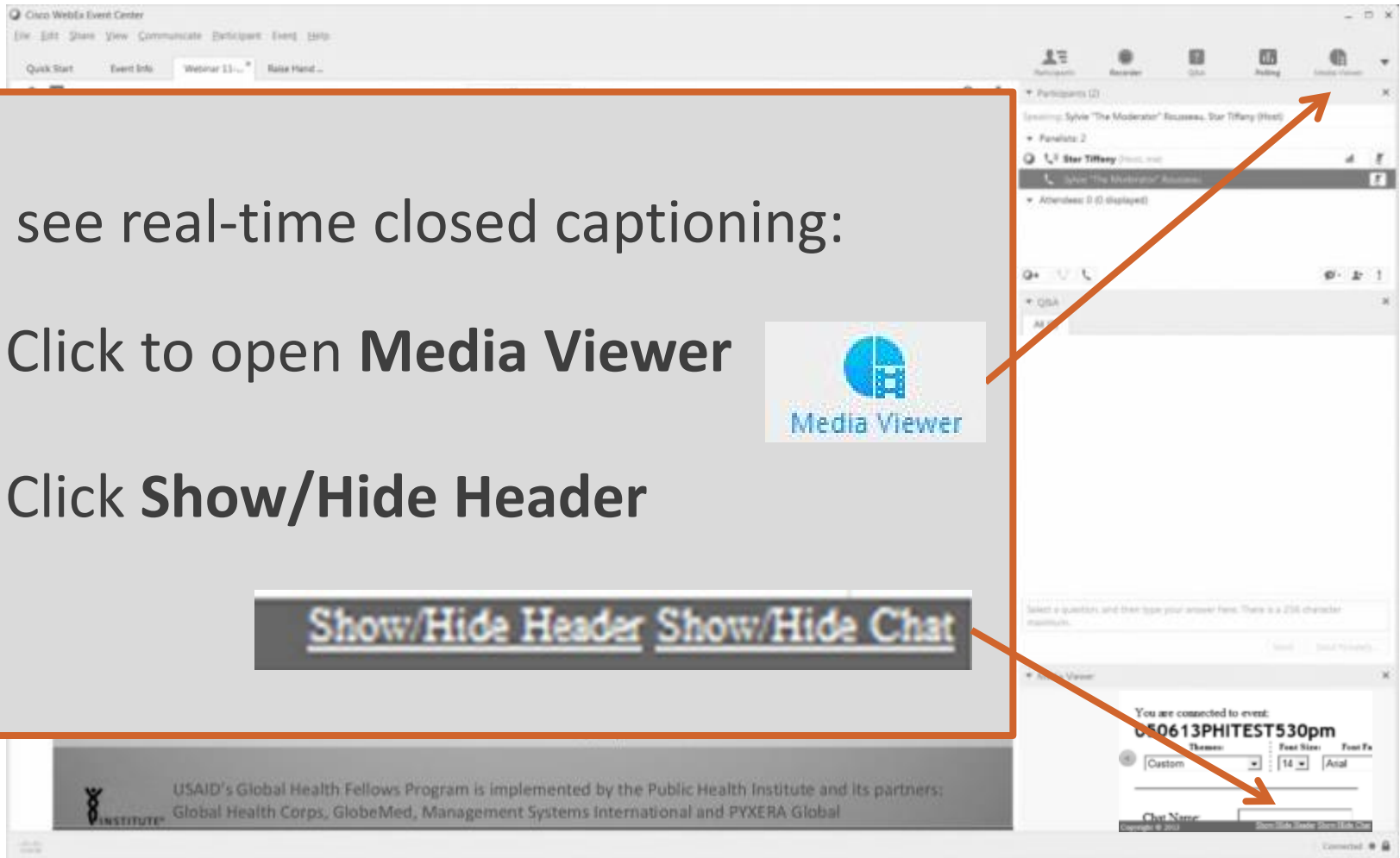
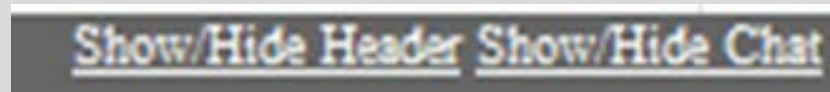

# Q&A Feature

1. Type your question in the **Q&A box**
2. Select **Ask: All Panelists**
3. Click **Send**

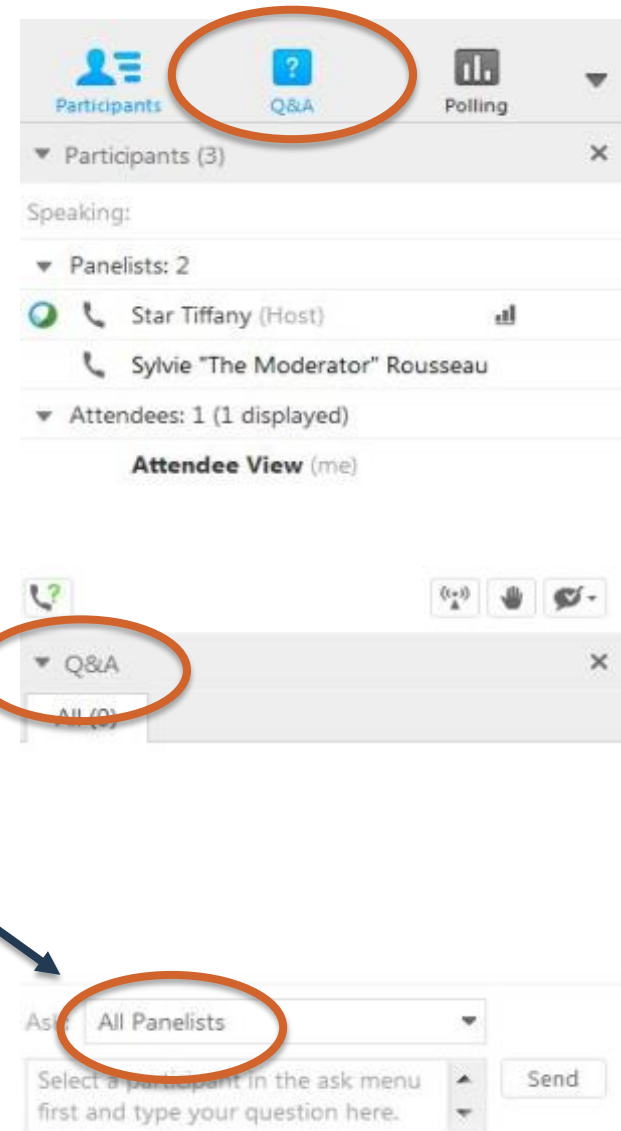

# Polling Feature

Please:

1. Choose your **answer**
2. Click **Submit**

Participants Q&A **Polling**

Participants (3) ×

Q&A ×

Polling ×

Time elapsed: 0:46 Time limit: 1:30

Poll Questions:

1. Are you attending this Web Forum:

- a. Individually
- b. In a group of 2-5 people
- c. In a group of 6-10 people
- d. In a group of more than 10 people

Submit

Your answer may be recorded.

# Poll #1

Are you attending this Web Forum:

- a) Individually
- b) In a group of 2-5 people
- c) In a group of 6-10 people
- d) In a group of more than 10 people



## **Kelly Hughes, MPH, RD, CHES**

Associate Director of Program Strategy  
National Network of Public Health Institutes

[www.nnphi.org](http://www.nnphi.org)



# Hadley Hickner MS, RD

Health Communications Specialist

Division for Heart Disease and Stroke  
Prevention

Centers for Disease Control and Prevention

[www.cdc.org](http://www.cdc.org)

# About the Audience: Where You Are

- In 47 US states, Washington DC, Puerto Rico, Canada, Senegal Republic, Indonesia, and the UK
- These states have 5 or more audience members:

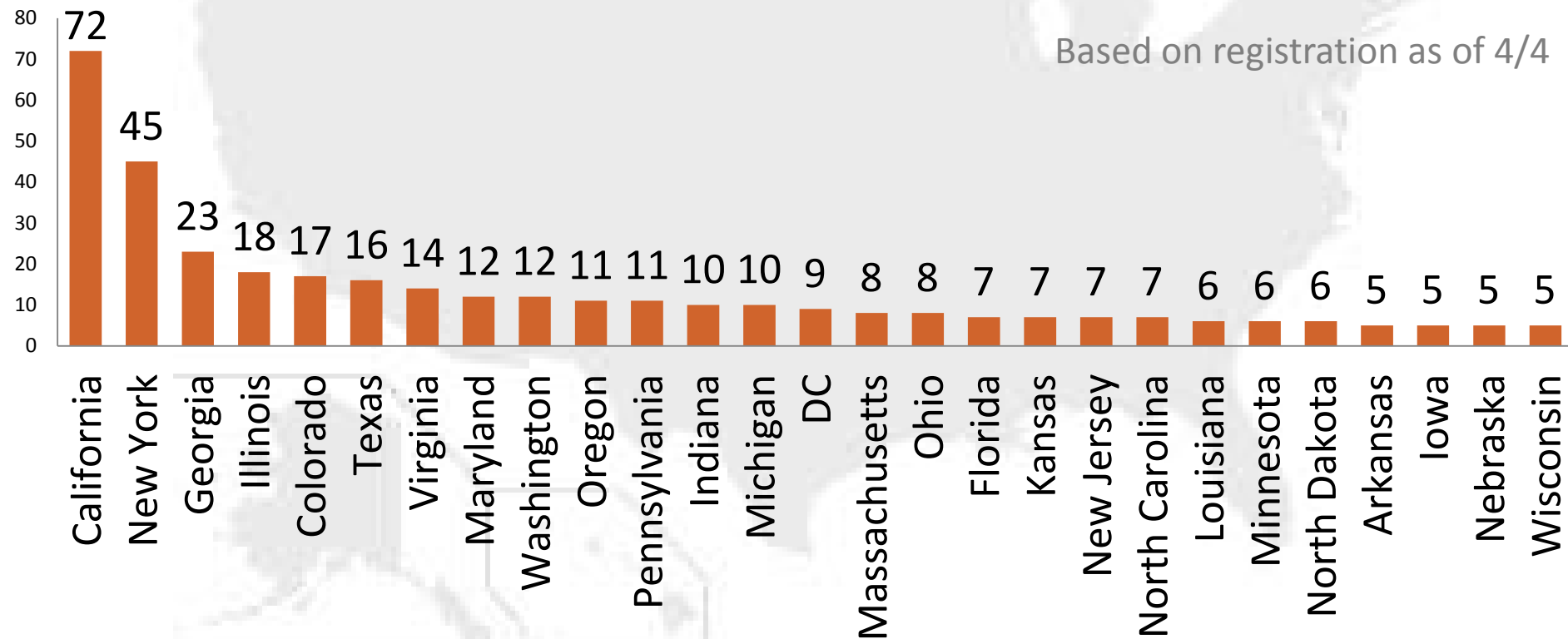



# About the Audience: Work Sectors

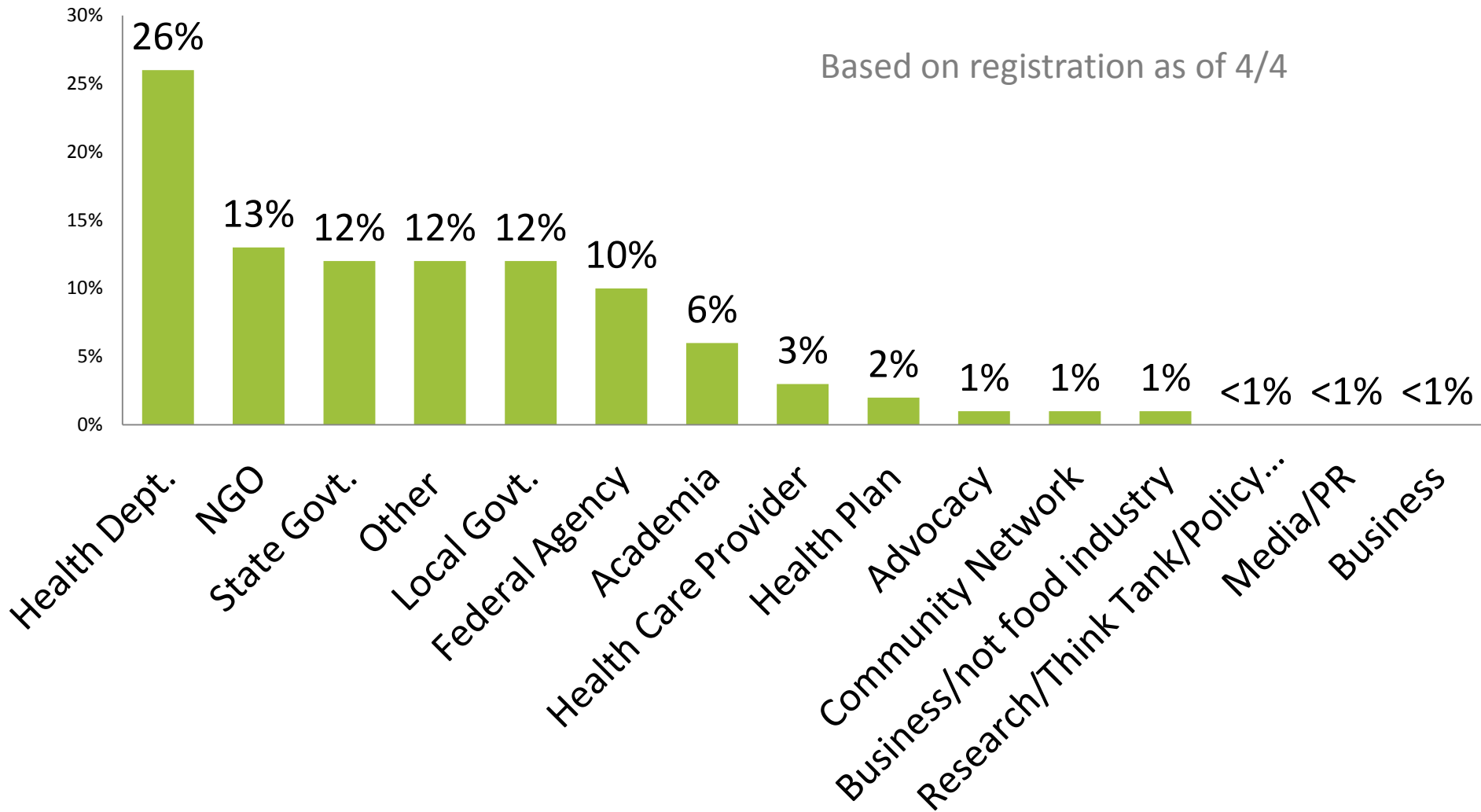

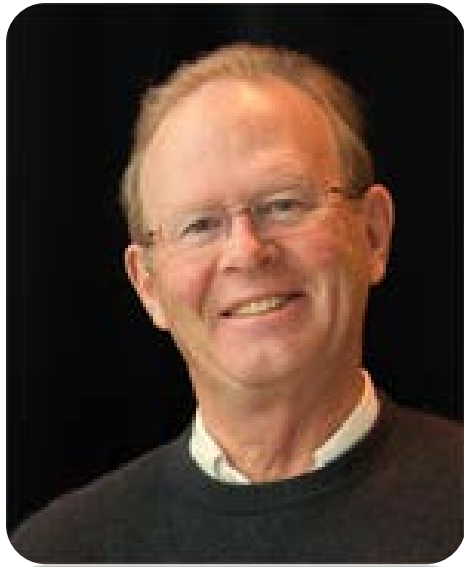

# John Graham, PhD

Senior Investigator

North Carolina Institute for Public Health in  
the UNC-CH Gillings School of Global  
Public Health

[www.sph.unc.edu](http://www.sph.unc.edu)



# Angelo Mojica, PhD, MPH

Senior Director

Johns Hopkins Health System

[www.hopkinsmedicine.org](http://www.hopkinsmedicine.org)



# John Whitehill, Jr., MPH

Health Scientist

Applied Research and Evaluation Branch

Division for Heart Disease and Stroke

Prevention, Centers for Disease Control  
and Prevention



[www.fns.usda.gov](http://www.fns.usda.gov)

## Erika Pijai, MS, RD

Senior Nutritionist / Senior Technical Advisor  
USDA Food and Nutrition Service, Child  
Nutrition Programs

# Q&A Feature

1. Type your question in the **Q&A box**
2. Select **Ask: All Panelists**
3. Click **Send**

The screenshot displays the Zoom meeting interface. At the top, the 'Q&A' icon is circled in orange. Below it, the 'Q&A' panel is also circled in orange, showing the 'Ask' dropdown menu with 'All Panelists' selected and circled in orange. A 'Send' button is visible to the right of the question input field.

# Thank you to our panelists!



**John  
Graham**



**John  
Whitehill**



**Angelo  
Mojica**



**Erika  
Pijai**

# Thank you!





# Connecting Public Health and Food Sector Collaborators: Reducing Sodium in Food Service Settings

**Thank you for joining our Web Forum!**

The **Recording** and **Slides** will be available next week at  
[www.Dialogue4Health.org](http://www.Dialogue4Health.org)

---

Join the  **LinkedIn Group** at  
[tinyurl.com/D4HGroup](http://tinyurl.com/D4HGroup)

---