

# Build Power for Health Equity: Strategic Practices for Local Health Departments

June 1, 2017

10 AM – 11:30 AM Pacific

1 PM – 2:30 PM Eastern

---

*Please close all applications except WebEx.*

**Audio trouble?** Send us a question in the **Q&A** panel.

**Technical trouble?** Call WebEx at **1-866-229-3239**.

Closed captioning instructions will be provided.

---

Connect with us on Twitter [@Dialogue4Health](https://twitter.com/Dialogue4Health) | [#HealthEquity](https://twitter.com/HealthEquity)

# Closed Captioning

To see real-time closed captioning:

1. Click to open **Media Viewer**



2. Click **Show/Hide Header**

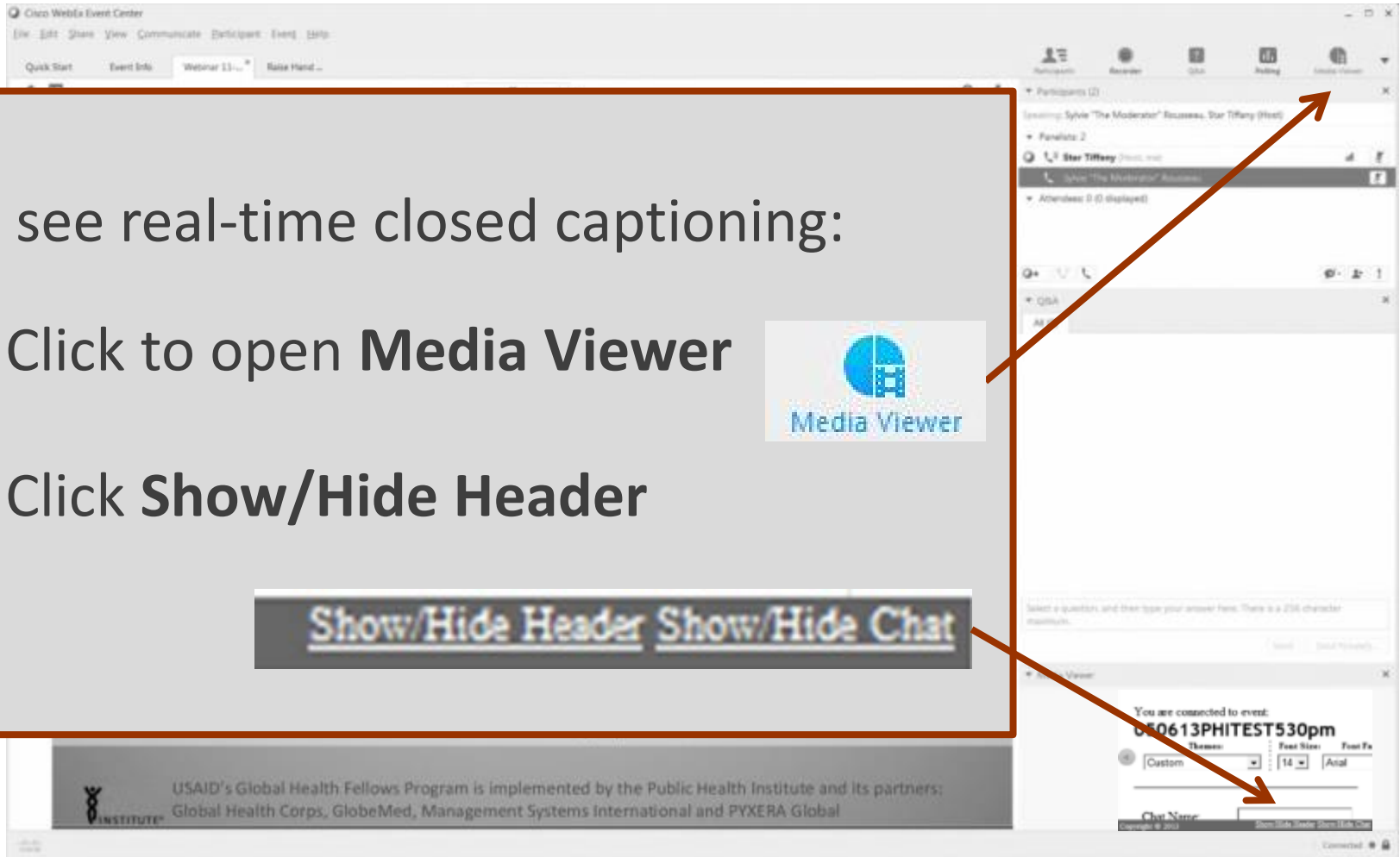
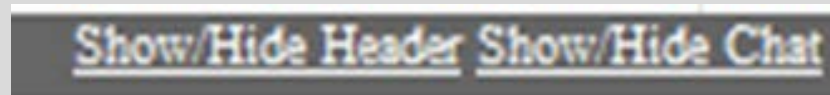

# Q&A Feature

1. Type your question in the **Q&A box**
2. Select **Ask: All Panelists**
3. Click **Submit**

The screenshot shows the Zoom meeting interface. At the top, the 'Q&A' icon is circled in orange. Below it, a dropdown menu is open, showing 'Q&A' and 'All (0)'. The 'All Panelists' option is circled in orange. A 'Send' button is visible. The interface also shows 'Participants (3)', 'Speaking:', 'Panelists: 2' (Star Tiffany (Host) and Sylvie "The Moderator" Rousseau), and 'Attendees: 1 (1 displayed)'. The current view is 'Attendee View (me)'.

# Polling Feature

Please:

1. Choose your **answer**
2. Click **Submit**

Participants Q&A **Polling**

Participants (3) x

Q&A x

Polling x

Time elapsed: 0:46 Time limit: 1:30

Poll Questions:

1. Are you attending this Web Forum:

a. Individually

b. In a group of 2-5 people

c. In a group of 6-10 people

d. In a group of more than 10 people

Submit

Your answer may be recorded.

# Poll #1

Are you attending this Web Forum:

- A. Individually
- B. In a group of 2-5 people
- C. In a group of 6-10 people
- D. In a group of more than 10 people

# Dialogue4Health welcomes today's partners and sponsor:





# Jonathan Heller, PhD

Co-Director and Co-Founder  
Human Impact Partners



[humanimpact.org](http://humanimpact.org)

# About the Audience: Where You Are

- In all 50 US states, Puerto Rico, Saipan, Canada, Colombia, Mexico, Peru, Portugal, and Qatar
- These states have at least 30 audience members:

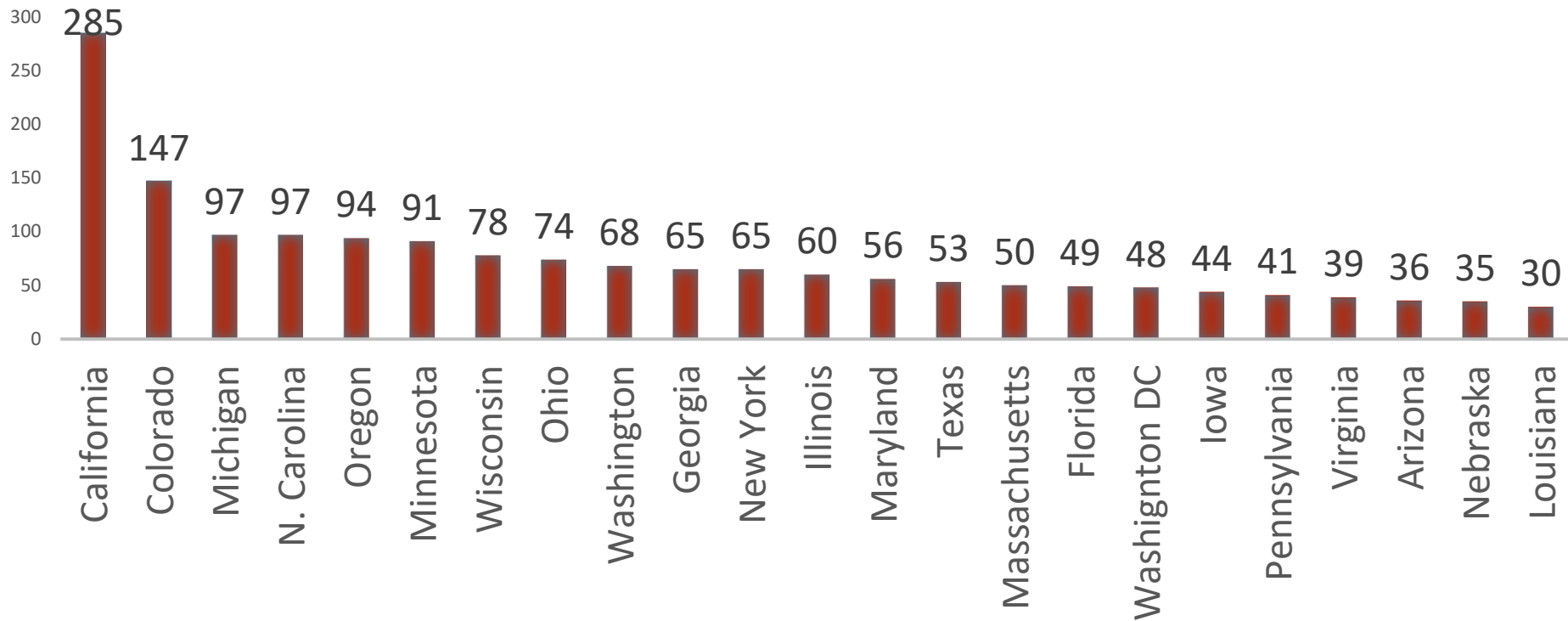



# About the Audience: Work Sectors

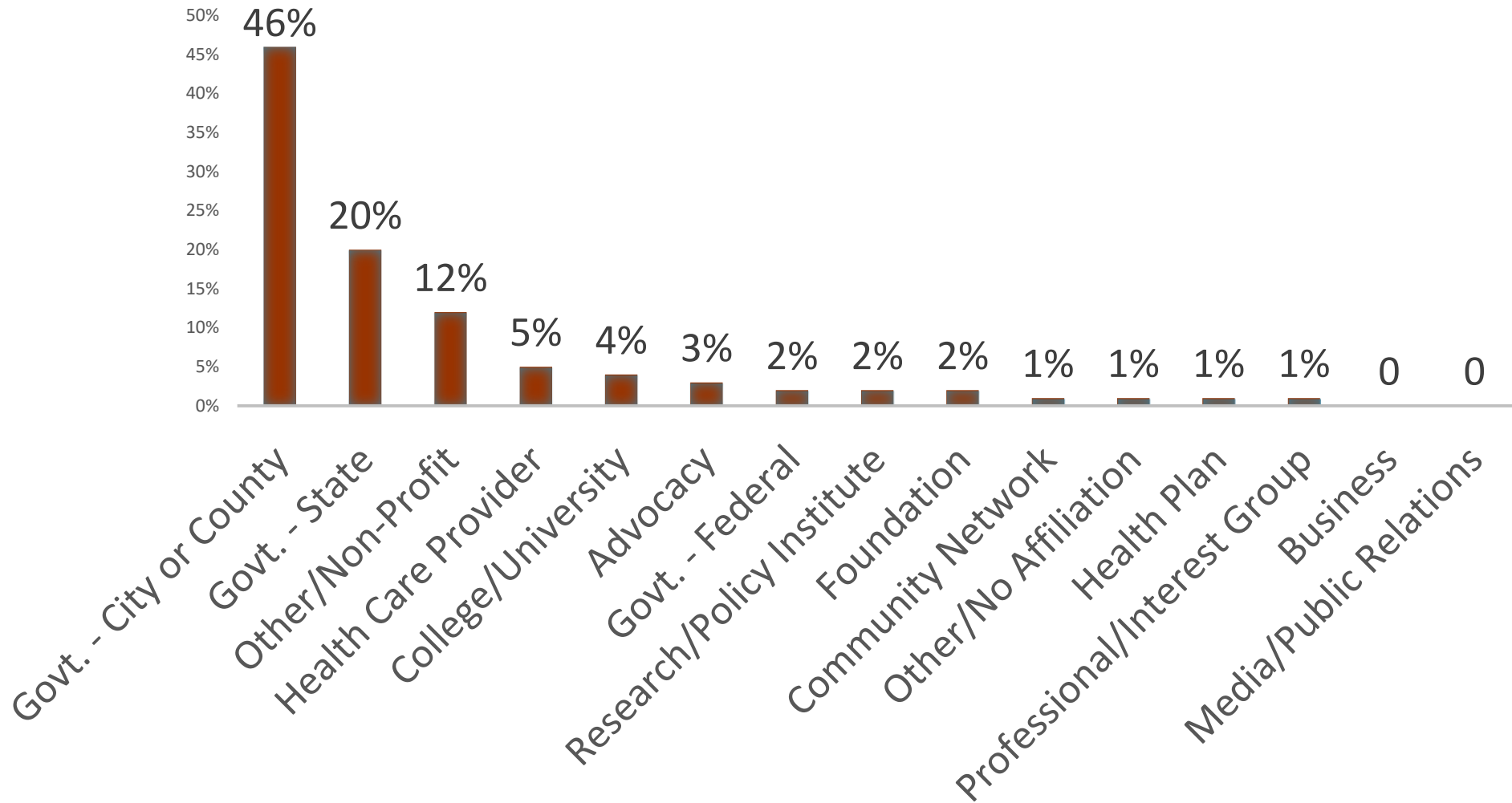



## Renée Canady, PhD

Chief Executive Officer  
Michigan Public Health Institute  
[mph.org](http://mph.org)



## Jacques Colon

Health Equity Coordinator  
Tacoma-Pierce County Health Department  
[tpchd.org](http://tpchd.org)



## Sarah Hernandez

Policy Analyst  
Office of Health Equity  
Colorado Department of Public Health and Environment  
[colorado.gov/pacific/cdphe/ohe](http://colorado.gov/pacific/cdphe/ohe)



**COLORADO**  
Department of Public  
Health & Environment

## Poll #2

Where is your health department with respect to **building internal infrastructure** to advance equity?

- A. Infancy
- B. Pre-teen
- C. Adult
- D. Wise elder

## Poll #3

Where is your health department with respect to **working across government** to advance equity?

- A. Infancy
- B. Pre-teen
- C. Adult
- D. Wise elder

# Poll #4

Where is your health department with respect to **fostering strategic community partnerships** to advance equity?

- A. Infancy
- B. Pre-teen
- C. Adult
- D. Wise elder

# Questions?

1. Type your question in the **Q&A box**
2. Select **Ask: All Panelists**
3. Click **Send**

The screenshot shows a meeting interface with a top navigation bar containing 'Participants', 'Q&A', and 'Polling'. The 'Q&A' icon is circled in orange. Below this, a 'Participants (3)' dropdown is visible. The main area shows 'Speaking:' and 'Panelists: 2' with names 'Star Tiffany (Host)' and 'Sylvie "The Moderator" Rousseau'. Below that, 'Attendees: 1 (1 displayed)' and 'Attendee View (me)'. A 'Q&A' panel is open, with the 'Q&A' dropdown circled in orange. Below it, the 'Ask' dropdown is set to 'All Panelists', which is also circled in orange. A 'Send' button is visible to the right of the 'Ask' dropdown. Arrows from the list items point to these circled elements.

# Thank you to our panelists!



**Jonathan  
Heller**



**Renée  
Canady**



**Sarah  
Hernandez**



**Jacques  
Colon**

# Thank you to our partners and sponsor:





# Build Power for Health Equity: Strategic Practices for Local Health Departments

**Thank you for joining our Web Forum!**

The **Recording** and **Slides** will be available next week at  
[Dialogue4Health.org](https://Dialogue4Health.org)

---

Join the **Dialogue4Health LinkedIn Group** at  
[tinyurl.com/D4HGroup](https://tinyurl.com/D4HGroup)

---