

Marijuana and Communities: Criminalization, Impact, and Moving Forward

November 30, 2017

10:30 AM to Noon Pacific

1:30 PM to 3 PM Eastern

Please close all applications except WebEx.

Audio trouble? Send us a question in the **Q&A** panel.

Technical trouble? Call WebEx at **1-866-229-3239**.

Closed captioning instructions will be provided.

Connect with us on Twitter [@Dialogue4Health](https://twitter.com/Dialogue4Health) | [#UnderstandingMarijuana](https://twitter.com/UnderstandingMarijuana)

Audio

Audio is through your computer speakers or headphones

No sound?

→ Unmute and turn up your speaker volume

Still no sound?

→ Click **Event Info** to see the phone number and dial in

Closed Captioning

To see real-time closed captioning:

1. Click to open **Media Viewer**



2. Click **Show/Hide Header**

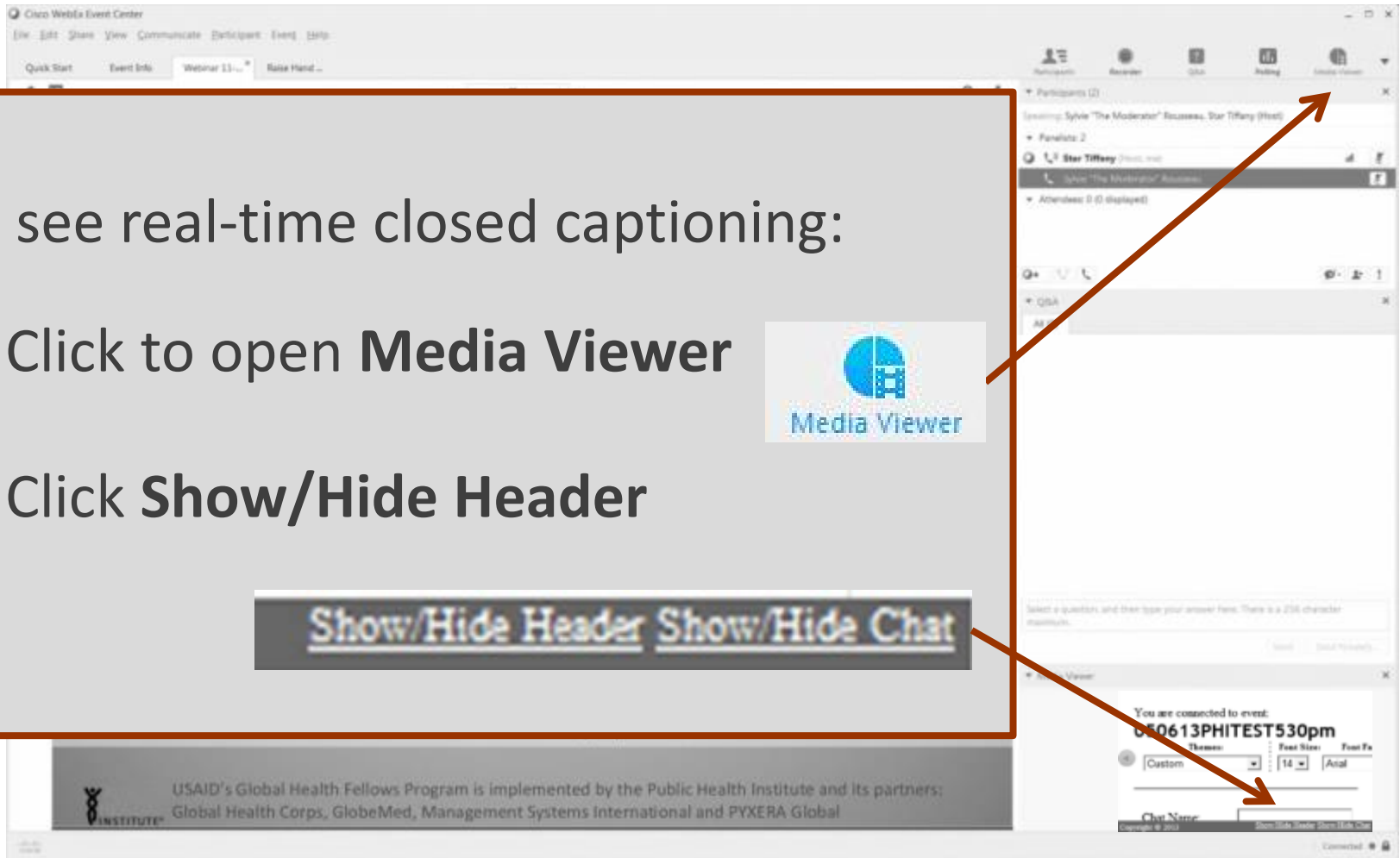
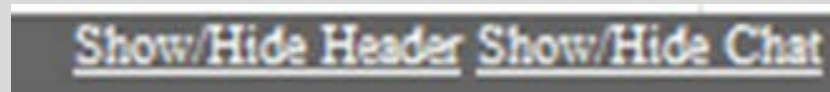

Q&A Feature

1. Type your question in the **Q&A box**
2. Select **Ask: All Panelists**
3. Click **Submit**

The image shows a screenshot of a Q&A interface. At the top, there are three icons: 'Participants', 'Q&A', and 'Polling'. The 'Q&A' icon is circled in orange. Below this, there is a 'Participants (3)' section. Underneath, there is a 'Speaking:' section, followed by 'Panelists: 2' and 'Attendees: 1 (1 displayed)'. The 'Attendee View (me)' section is visible. In the bottom right corner, there is a 'Q&A' box with a dropdown menu set to 'All (0)'. This dropdown menu is circled in orange. Below the dropdown, there is a text input field with the placeholder text 'Select a participant in the ask menu first and type your question here.' and a 'Send' button. The 'Send' button is also circled in orange. Arrows from the text on the left point to these circled elements.

Poll Question

Are you attending this Web Forum:

- A. Individually
- B. In a group of 2-5 people
- C. In a group of 6-10 people
- D. In a group of more than 10 people



Kristania De Leon

Project Manager

CA4Health

Public Health Institute

CA4Health.org

CA4Health

About the Audience: Where You Are

- In 47 US states, Canada, and Ivory Coast
- These states have more than 5 audience members:

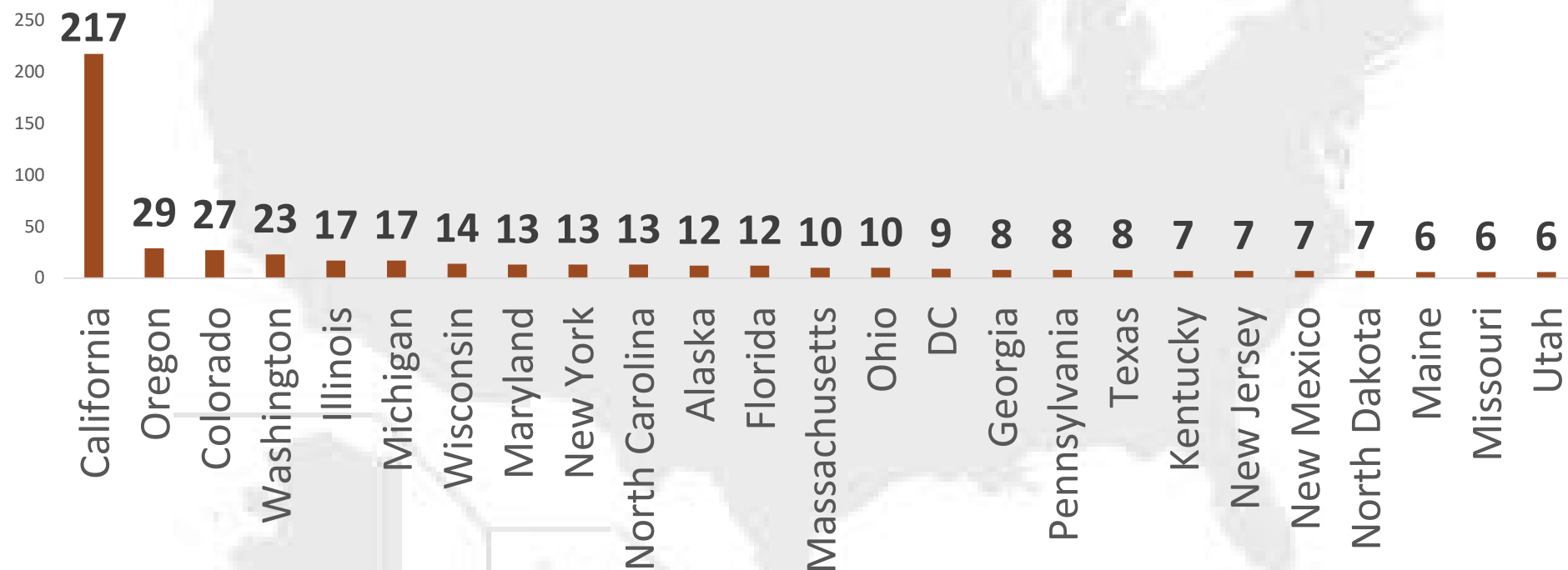

About the Audience: Work Sectors

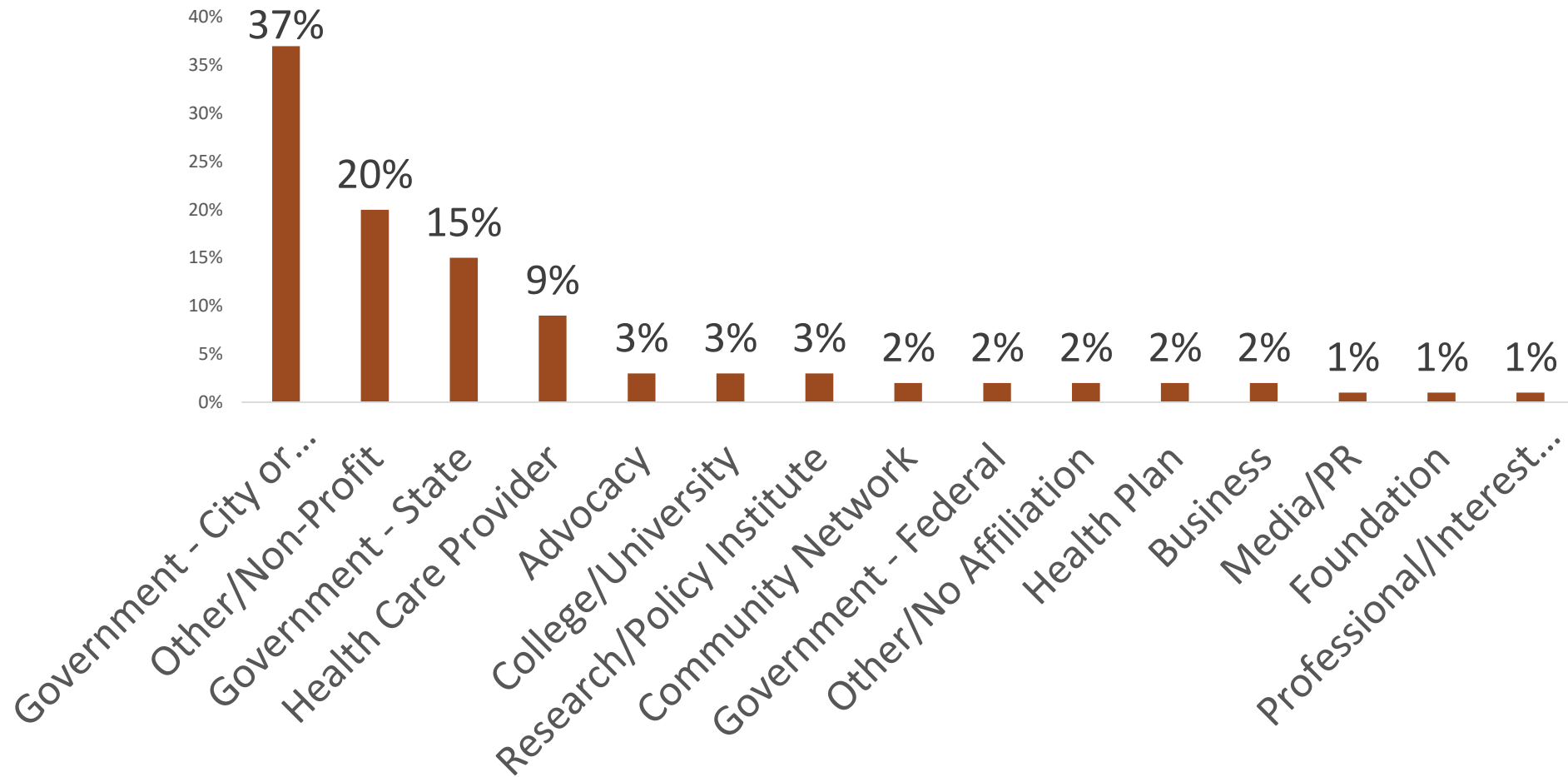



Jolene Forman, JD

Staff Attorney
Drug Policy Alliance

drugpolicy.org



Diane Goldstein

Lt. Commander (Ret.)

Law Enforcement Action Partnership (LEAP)

lawenforcementactionpartnership.org



Juell Stewart, MCP

Communications Director
Hood Incubator

hoodincubator.org

Questions?

1. Type your question in the **Q&A box**
2. Select **Ask: All Panelists**
3. Click **Send**

The screenshot shows a meeting interface with a top navigation bar containing 'Participants', 'Q&A', and 'Polling'. Below this, there are sections for 'Participants (3)', 'Speaking:', 'Panelists: 2' (listing Star Tiffany (Host) and Sylvie "The Moderator" Rousseau), and 'Attendees: 1 (1 displayed)'. The 'Attendee View (me)' section is visible. A 'Q&A' panel is open, showing a 'Q&A' dropdown menu and a 'Send' button. The 'Ask:' dropdown is set to 'All Panelists'. A text box below the dropdown contains the instruction: 'Select a participant in the ask menu first and type your question here.'



**Kristania
De Leon**



**Diane
Goldstein**



**Jolene
Forman**



**Juell
Stewart**

**Thank you for attending Session 2 of the
Understanding Marijuana Web Forum Series!**

**Please register for Session 3
at dialogue4health.org**

SESSION 3

**Marijuana and Public Health: Opportunities for Equitable Policies and
Approaches**

December 14, 2017, 10:30 AM - 12 PM Pacific / 1:30 PM to 3 PM Eastern

Thank you to our host & presenters!



**Kristania
De Leon**



**Jolene
Forman**



**Diane
Goldstein**



**Juell
Stewart**

Thank you to our partner and sponsor:

CA⁴Health



Marijuana and Communities: Criminalization, Impact, and Moving Forward

Thank you for joining our Web Forum!

The **Recording** and **Slides** will be available by next week at
Dialogue4Health.org

Join the **Dialogue4Health LinkedIn Group** at
tinyurl.com/D4HGroup
