

# HI-5: Exploring Community-Wide Interventions That Have Health Impact in 5 Years

Tuesday, August 9, 2016

11 AM – 12:30 PM Pacific

2 PM – 3:30 PM Eastern

Connect with us: **Twitter** [@Dialogue4Health](https://twitter.com/Dialogue4Health) | #HI5initiative

---

**Audio difficulties?** Send us a question in the **Q&A** panel.

**Technical difficulties?** Call WebEx at **1-866-229-3239**.

---

# Closed Captioning

To see real-time closed captioning:

1. Click to open **Media Viewer**



2. Click **Show/Hide Header**

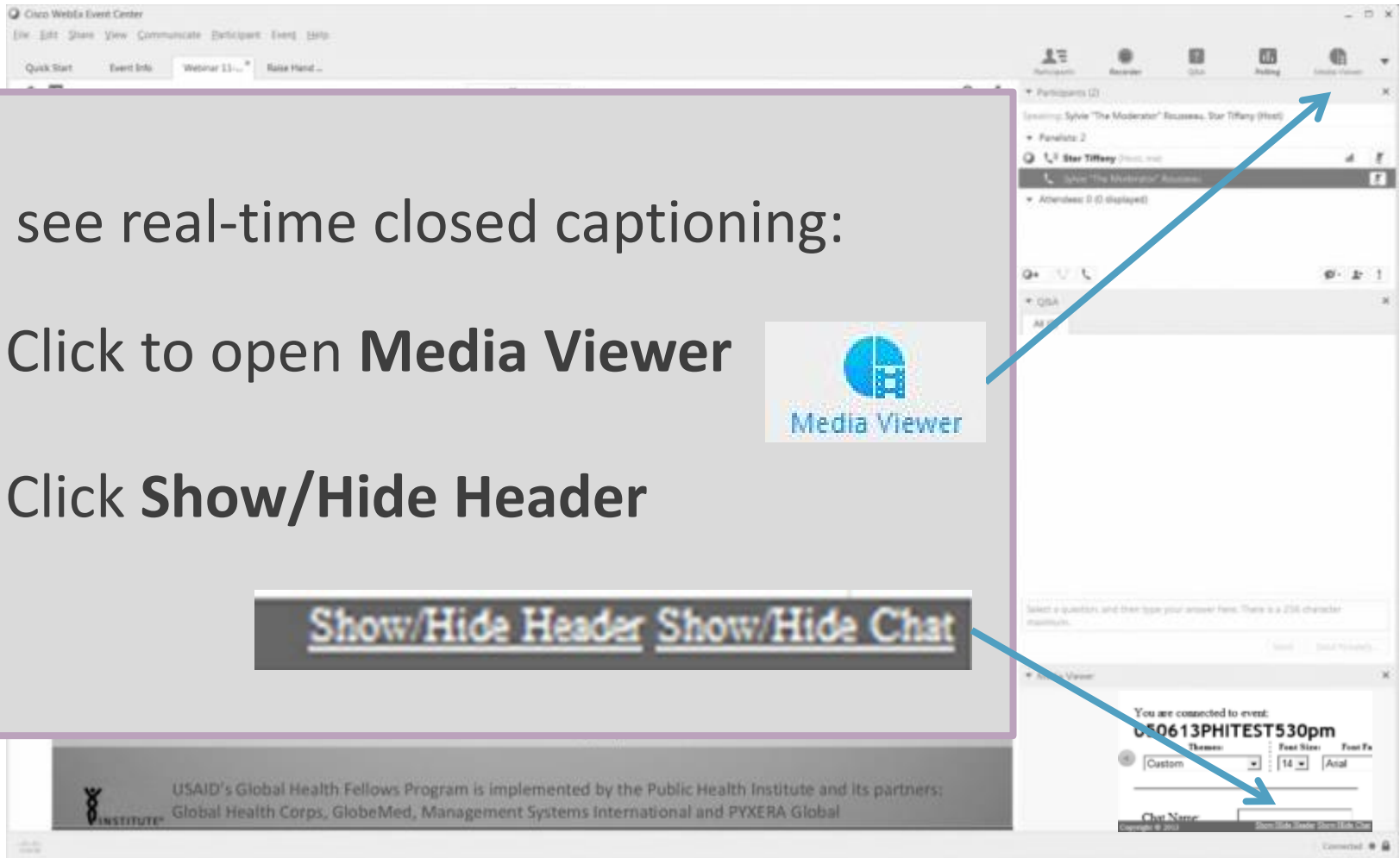
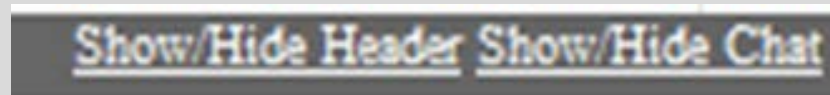

# Q&A Feature

1. Type your question in the **Q&A box**
2. Select **Ask: All Panelists**
3. Send

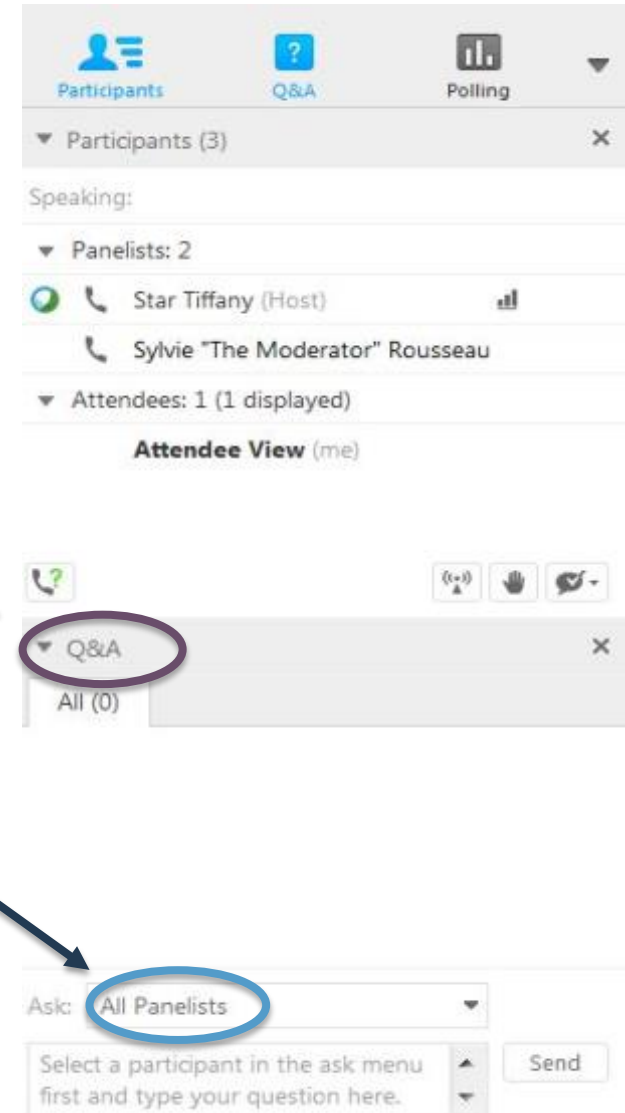

# Polling Feature

Please:

1. Choose your **answer**
2. Click **Submit**

The screenshot shows a web interface with a top navigation bar containing three icons: 'Participants' (person icon), 'Q&A' (question mark icon), and 'Polling' (bar chart icon). Below the navigation bar is a list of active features: 'Participants (3)', 'Q&A', and 'Polling'. A timer shows 'Time elapsed: 0:46' and 'Time limit: 1:30'. The main content area displays a poll question: '1. Are you attending this Web Forum:'. There are four radio button options: 'a. Individually' (which is selected and highlighted in blue), 'b. In a group of 2-5 people', 'c. In a group of 6-10 people', and 'd. In a group of more than 10 people'. A 'Submit' button is located at the bottom right of the poll area. Below the button, the text 'Your answer may be recorded.' is visible.

# Poll #1

**Are you attending this Web Forum:**

- a) Individually
- b) In a group of 2-5 people
- c) In a group of 6-10 people
- d) In a group of more than 10 people



## **Lolita Ross, MPPA, PMP**

Chief Program Officer

National Network of Public Health Institutes

**Website:** [www.nnphi.org](http://www.nnphi.org)

# About the Audience: Where You Are

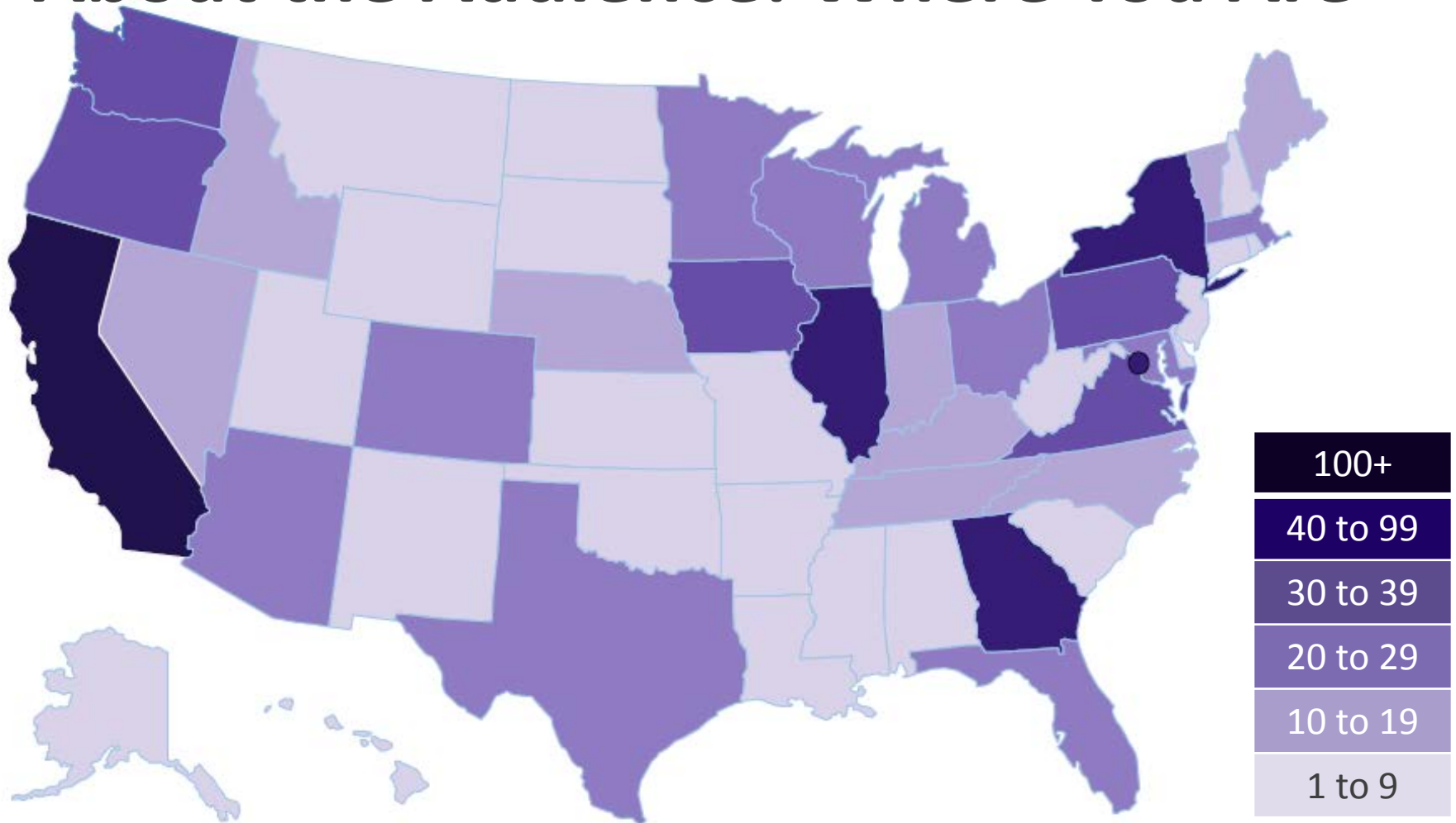

Based on registration as of 7/28/16

# About the Audience: Work Sectors

Based on registration as of 07/28/16

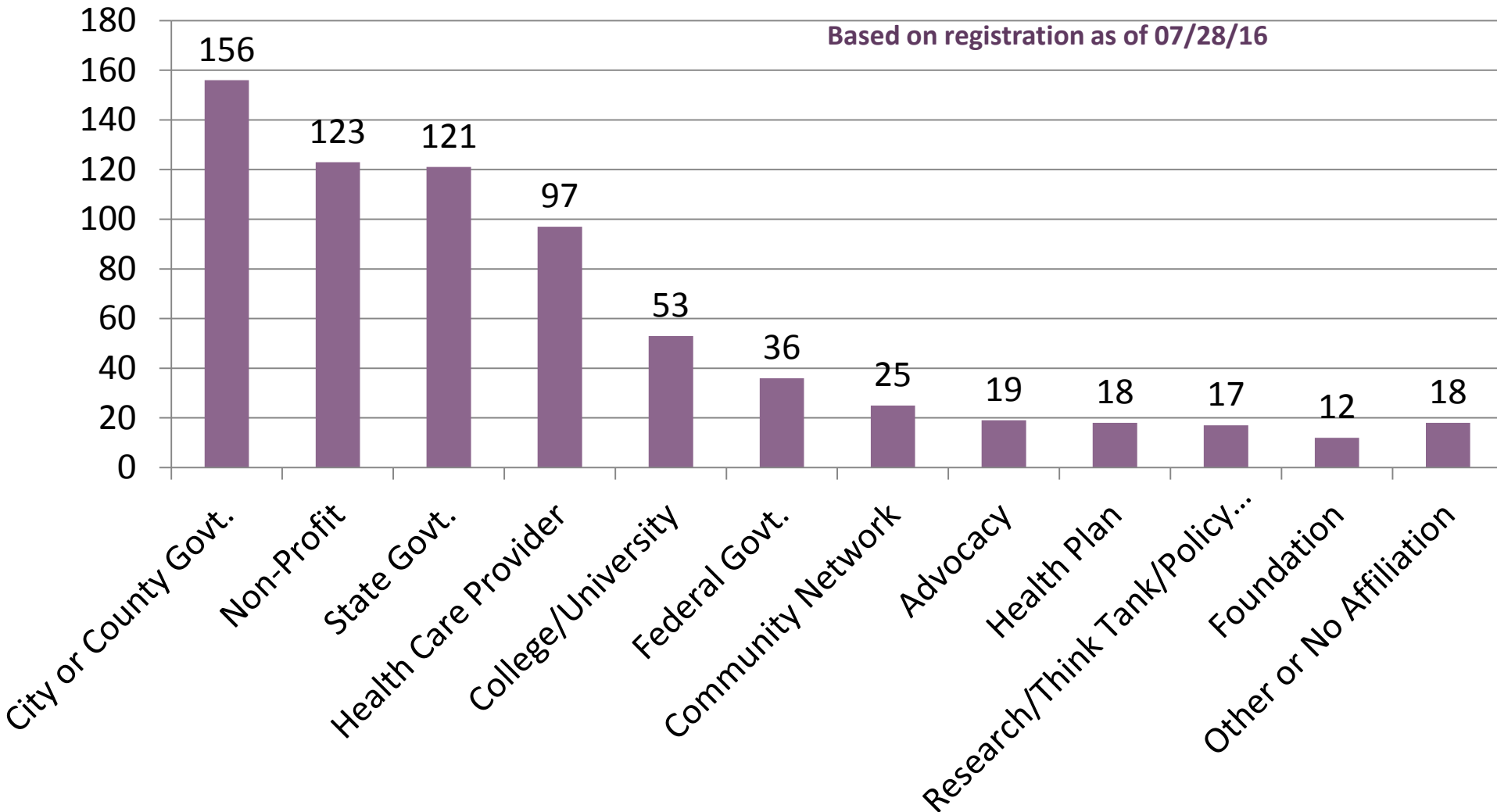



# Welcome to our presenters:



**John  
Auerbach**



**W. Steven  
Barnett**



**Natalie  
Renew**



**Elizabeth  
Skillen**



**Susan  
Adams**



# John Auerbach, MBA

Associate Director for Policy  
CDC

**Website:** [www.cdc.gov](http://www.cdc.gov)



## Elizabeth Skillen, PhD

Senior Advisor,  
Policy, Research, Development and Analysis Office,  
Office of the Associate Director for Policy,  
CDC

Website: [www.cdc.gov](http://www.cdc.gov)

# Poll #2

**Which HI-5 interventions are you currently working and/or partnering on? Click all that apply:**

- a) School-based Programs to Increase Physical Activity
- b) School-based Violence Prevention
- c) Safe Routes to School
- d) Motorcycle Injury Prevention
- e) Tobacco Control Interventions
- f) Access to Clean Syringes
- g) Pricing Strategies for Alcohol Products
- h) Worksite Obesity Prevention
- i) Early Childhood Education
- j) Clean Diesel Bus Fleets
- k) Public Transportation System
- l) Home Improvement Loans/Grants
- m) Earned Income Tax Credits
- n) Water Fluoridation

# Q&A Feature

1. Type your question in the **Q&A box**
2. Select **Ask: All Panelists**
3. Send

The screenshot displays the Zoom meeting interface with the Q&A feature. At the top, there are icons for 'Participants', 'Q&A', and 'Polling'. Below these, the 'Participants (3)' section shows 'Speaking:' and 'Panelists: 2' (Star Tiffany (Host) and Sylvie 'The Moderator' Rousseau). The 'Attendees: 1 (1 displayed)' section shows 'Attendee View (me)'. A 'Q&A' box is visible, with 'Q&A' circled in purple. Below it, the 'Ask:' dropdown menu is open, showing 'All Panelists' circled in blue. A 'Send' button is also visible.



# W. Steven Barnett, PhD

Director

National Institute for Early Education Research

**Website:** [www.nieer.org](http://www.nieer.org)

## Poll #3

**Please rate your familiarity with the health impacts of early childhood education.**

- a) Not familiar
- b) Somewhat familiar
- c) Familiar
- d) Very familiar



# Susan Adams, MA

Assistant Commissioner  
Georgia's Pre-K and Instructional Supports

**Website:** [www.decal.ga.gov](http://www.decal.ga.gov)



## Poll #4

**Please rate your familiarity with the cost savings associated with early childhood education.**

- a) Not familiar
- b) Somewhat familiar
- c) Familiar
- d) Very familiar



## **Natalie Renew, MPA**

Manager Director of Early Childhood Education  
Public Health Management Corporation

**Website:** [www.phmc.org](http://www.phmc.org)

# Q&A Feature

1. Type your question in the **Q&A box**
2. Select **Ask: All Panelists**
3. Send

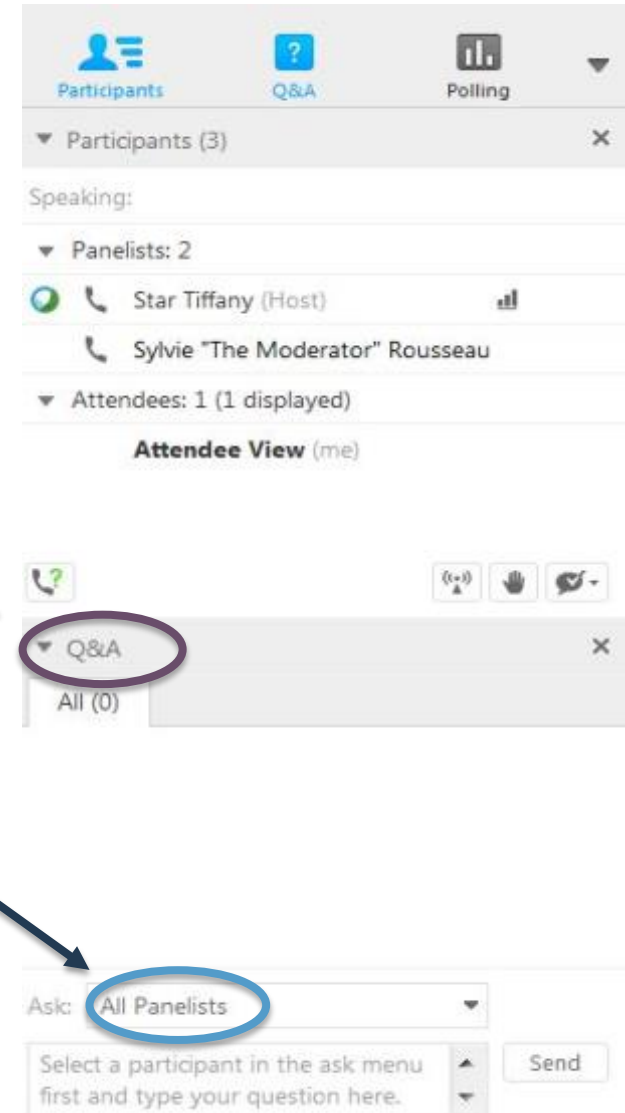

# Thank you to our moderator and presenters:



**Lolita  
Ross**



**Elizabeth  
Skillen**



**Susan  
Adams**



**John  
Auerbach**



**W. Steven  
Barnett**



**Natalie  
Renew**

# Thank you!

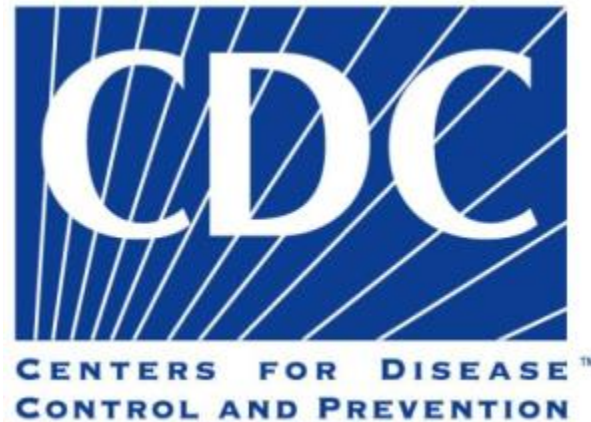

# HI-5: Exploring Community-Wide Interventions That Have Health Impact in 5 Years

**Thank you for joining our Web Forum!**

The **Recording** and **Slides** will be available at  
[www.Dialogue4Health.org](http://www.Dialogue4Health.org)

---

Join the new **Dialogue4Health LinkedIn Group**

---