

Marijuana and Our Health: What We Do and Don't Know

November 14, 2017

10:30 AM to Noon Pacific

1:30 PM to 3 PM Eastern

Please close all applications except WebEx.

Audio trouble? Send us a question in the **Q&A** panel.

Technical trouble? Call WebEx at **1-866-229-3239**.

Closed captioning instructions will be provided.

Connect with us on Twitter [@Dialogue4Health](https://twitter.com/Dialogue4Health) | [#UnderstandingMarijuana](https://twitter.com/UnderstandingMarijuana)

Audio

Audio is through your computer speakers or headphones

No sound?

→ Unmute and turn up your speaker volume

Still no sound?

→ Click **Event Info** to see the phone number and dial in

Closed Captioning

To see real-time closed captioning:

1. Click to open **Media Viewer**



2. Click **Show/Hide Header**

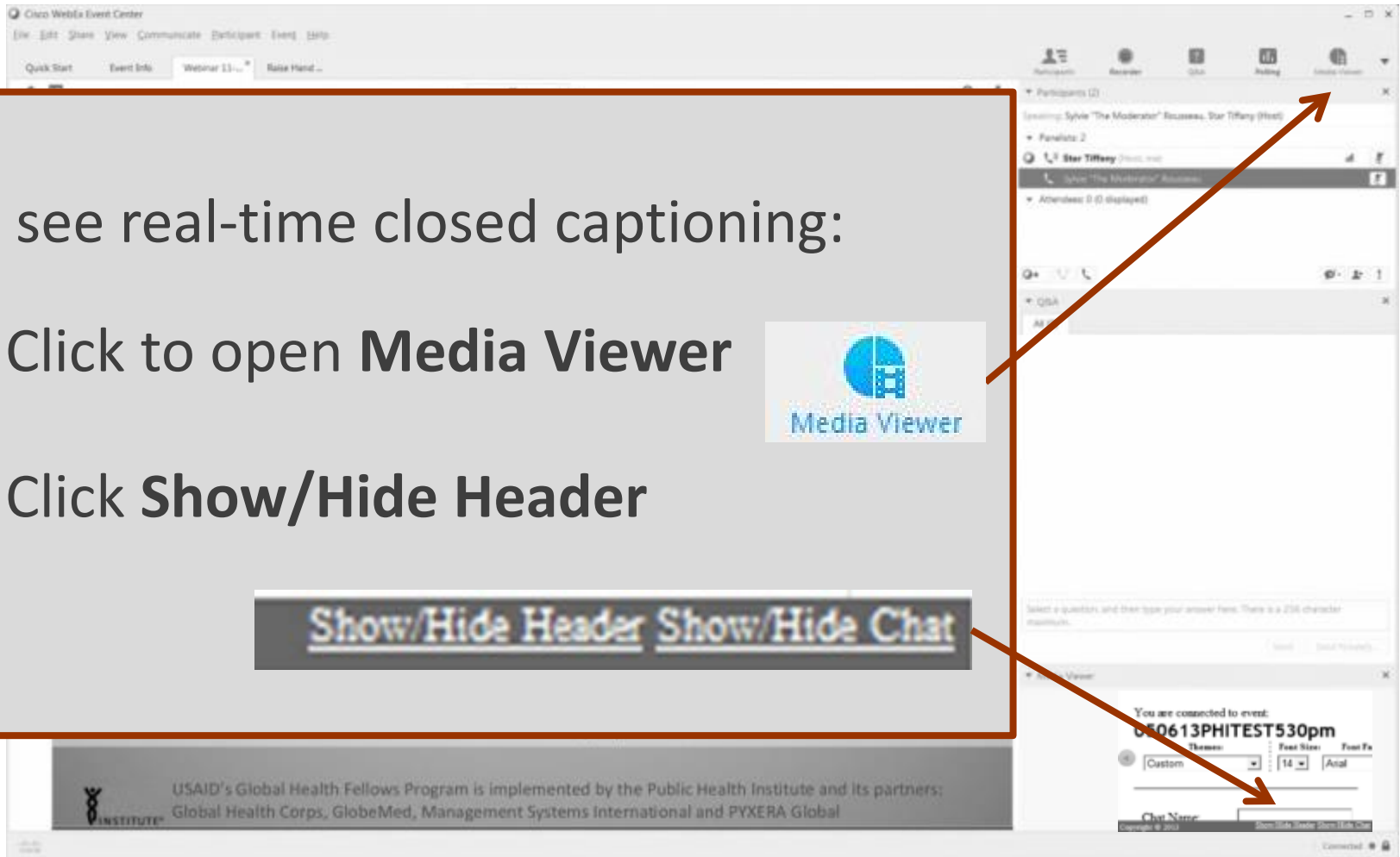
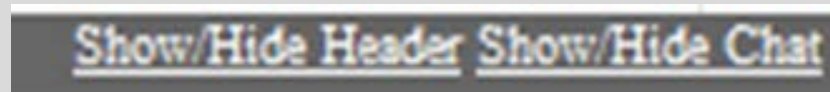

Q&A Feature

1. Type your question in the **Q&A box**
2. Select **Ask: All Panelists**
3. Click **Submit**

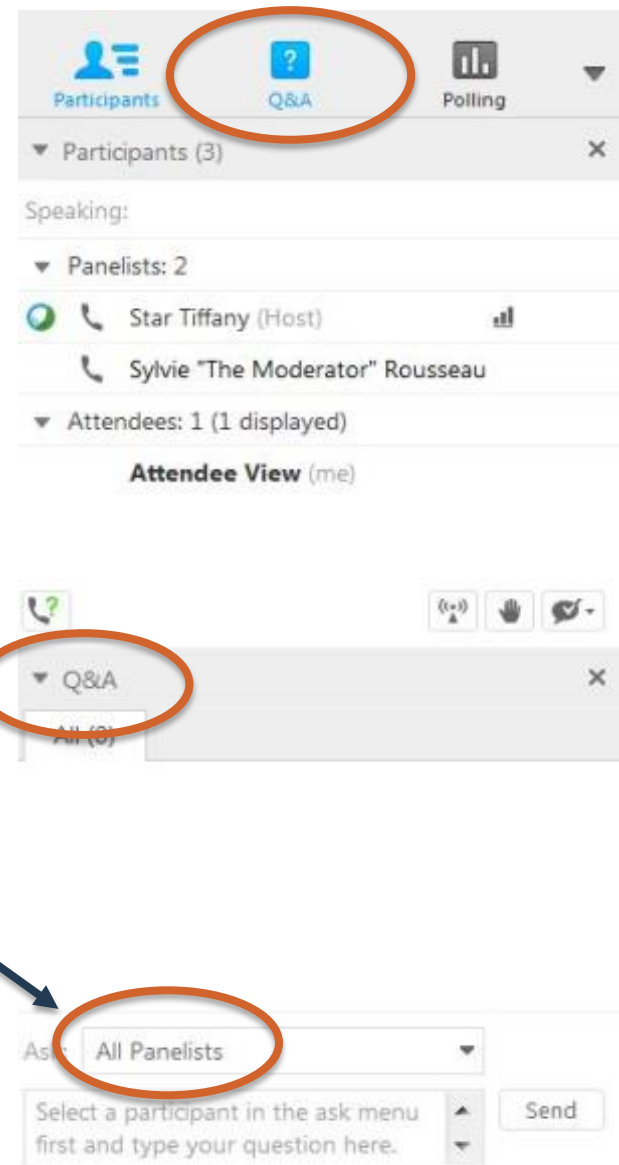

Polling Feature

Please:

1. Choose your **answer**
2. Click **Submit**

Participants Q&A **Polling**

Participants (3) X

Q&A X

Polling X

Time elapsed: 0:46 Time limit: 1:30

All Questions:

1. Are you attending this Web Forum:

a. Individually

b. In a group of 2-5 people

c. In a group of 6-10 people

d. In a group of more than 10 people

Submit

Your answer may be recorded.

Poll #1

Are you attending this Web Forum:

- A. Individually
- B. In a group of 2-5 people
- C. In a group of 6-10 people
- D. In a group of more than 10 people



Susan Watson, MPH

Program Director

CA4Health

Public Health Institute

[CA4Health.org](https://www.ca4health.org)

CA4Health

About the Audience: Where You Are

- In 50 US states, Guam, Puerto Rico, Canada, Ivory Coast, Tanzania, and France
- These states have more than 15 audience members:

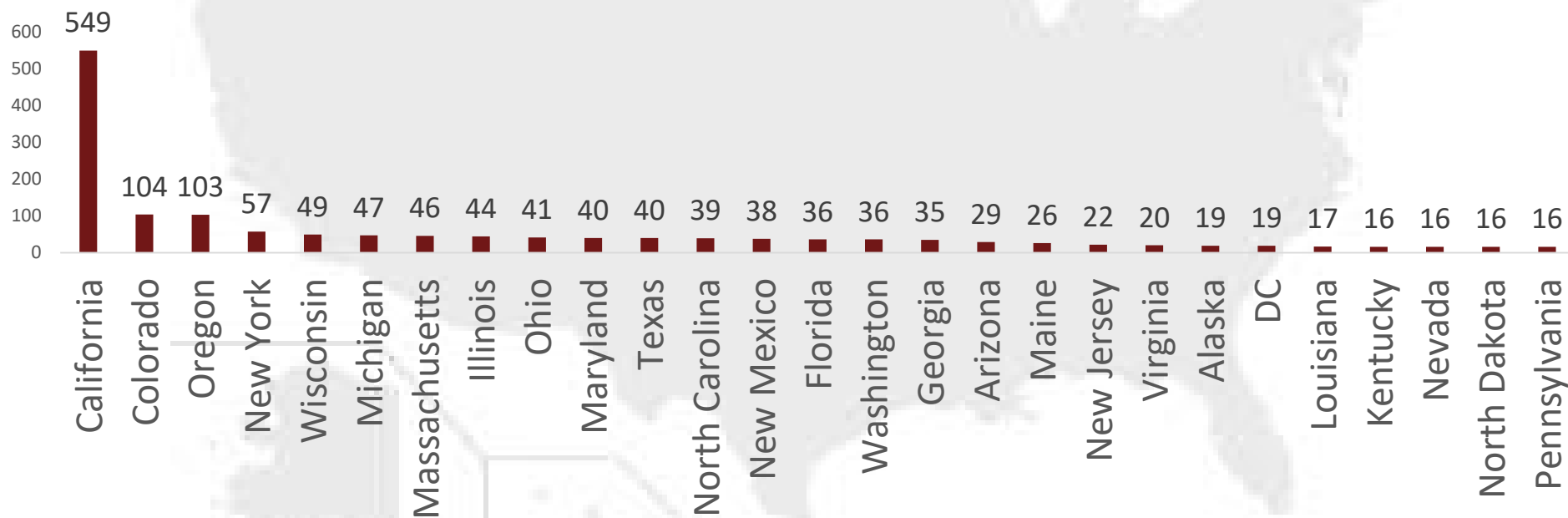

About the Audience: Work Sectors

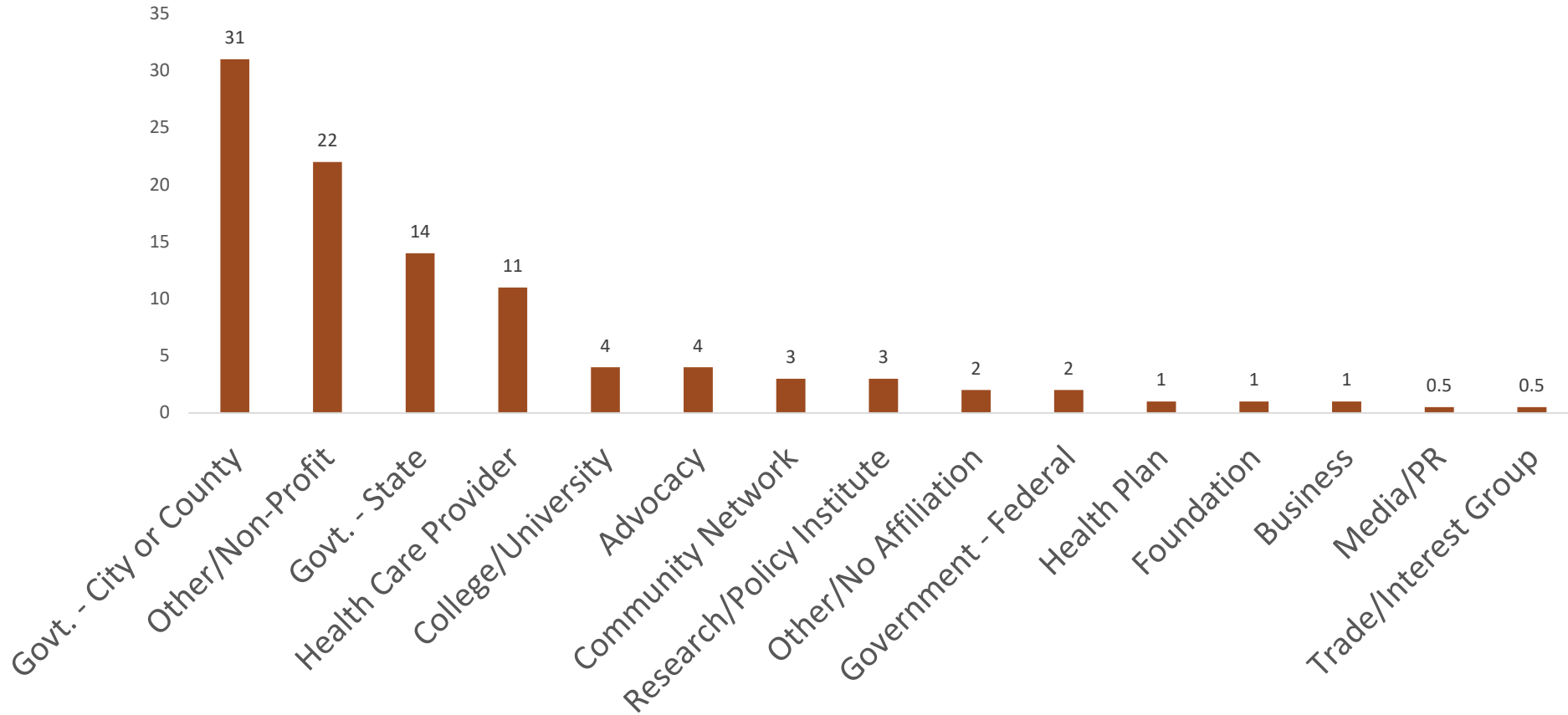

Poll #2

1. **Marijuana is a gateway drug—it generally leads to the use of more potent drugs like heroin, cocaine, etc.**
 - a. True
 - b. False

2. **Marijuana use negatively impacts mental health and can cause permanent mental illness.**
 - a. True
 - b. False

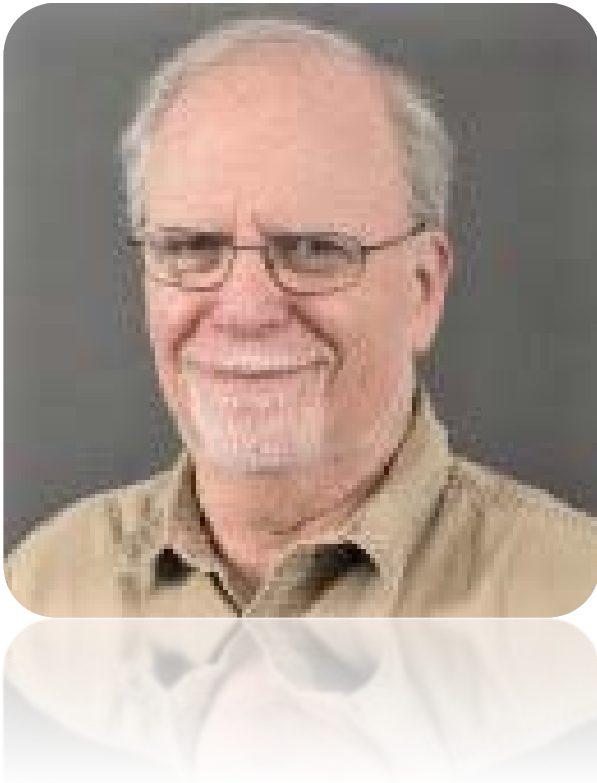

Robert Wallace, MD, MSc

Professor

University of Iowa College of Public Health

Committee Member

National Academies report on *The Health Effects of Cannabis and Cannabinoids: The Current State of Evidence Recommendations for Research*

public-health.uiowa.edu

Poll #3

1. Legalization of marijuana leads to increased use.
 - a. True
 - b. False

2. Marijuana impairs driving the way alcohol does.
 - a. True
 - b. False



Daniel Vigil, MD, MPH

Project Manager

Colorado Marijuana Health Monitoring and
Research Program

colorado.gov/pacific/cdphe

True or False or ???

- Gateway drug
- Mental health
- Legalization and use
- Driving impairment

Questions?

1. Type your question in the **Q&A box**
2. Select **Ask: All Panelists**
3. Click **Send**

The screenshot displays the Zoom meeting interface. At the top, the navigation bar includes 'Participants', 'Q&A', and 'Polling'. The 'Q&A' icon is circled in orange. Below this, the meeting details show 'Participants (3)', 'Speaking:' (empty), 'Panelists: 2' (Star Tiffany (Host) and Sylvie "The Moderator" Rousseau), and 'Attendees: 1 (1 displayed)'. The view is set to 'Attendee View (me)'. In the bottom right corner, the 'Q&A' dropdown menu is open, showing 'Q&A' and 'All (0)'. The 'Q&A' dropdown is circled in orange. Below the dropdown, the 'Ask:' menu is set to 'All Panelists', which is also circled in orange. A 'Send' button is visible to the right of the text input area.

**Thank you for attending Session 1 of the
Understanding Marijuana Web Forum series!**

**Please register for Sessions 2 & 3
at dialogue4health.org**

SESSION 2

Marijuana and Communities: Criminalization, Impact, and Moving Forward

November 30, 2017, 10:30 AM - 12 PM Pacific / 1:30 PM to 3 PM Eastern

SESSION 3

**Marijuana and Public Health: Opportunities for Equitable Policies and
Approaches**

December 14, 2017, 10:30 AM - 12 PM Pacific / 1:30 PM to 3 PM Eastern

Thank you to our host & presenters!



**Sue
Watson**

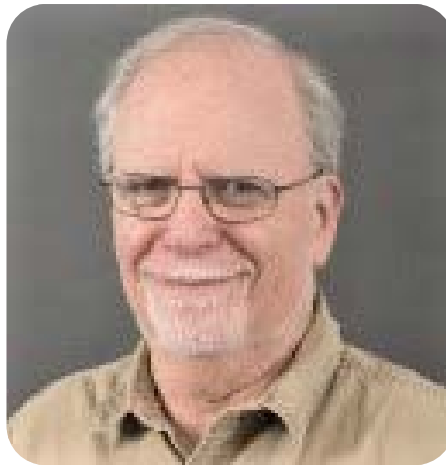

**Robert
Wallace**



**Daniel
Vigil**

Thank you to our partner and sponsor:

CA⁴Health



Marijuana and Our Health: What We Do and Don't Know

Thank you for joining our Web Forum!

The **Recording** and **Slides** will be available in 3 days at
Dialogue4Health.org

Join the **Dialogue4Health LinkedIn Group** at
tinyurl.com/D4HGroup
